

Dimension:  
Unit:mm

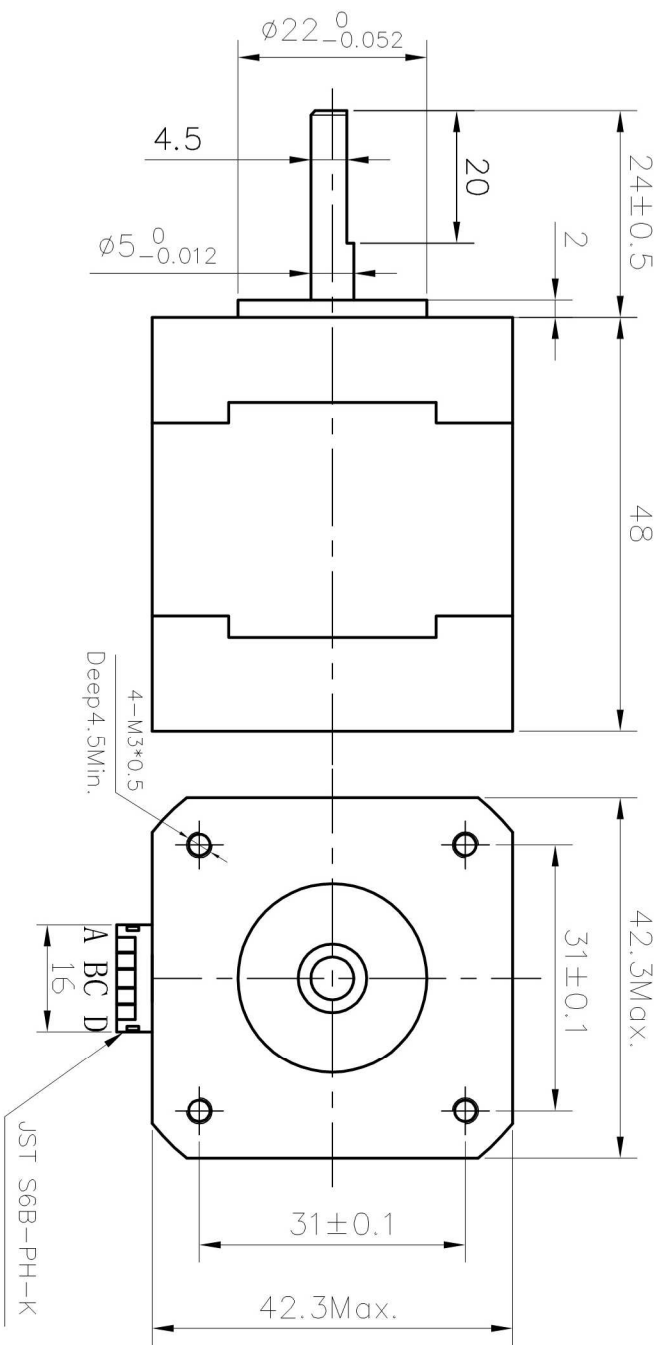

Wiring Diagram:

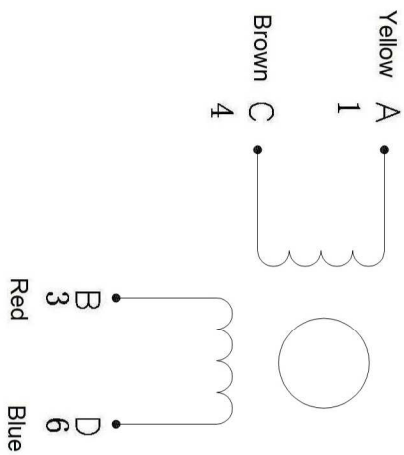

Specifications:

Phase	2	Comment
Step Angle	1.8	deg.
Voltage	2.8	V
Current	1.68	A
Resistance	$1.65 \pm 10\%$	$\Omega$
Inductance	$2.8 \pm 20\%$	mH
Holding Torque	5.0	kg.cm
Insulation Class	B	
Mass	0.34	kg
Color	Black	

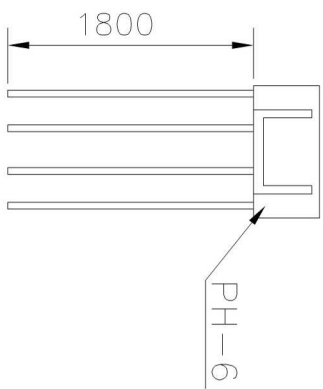

Title:  
Specification

SM1-8-A1748SPNBK-CS

**Motor Type: SM1.8-A1748SPNBK-CS**

**1.75A/ PH 400step/ rev 24VDC**

