

Dimension:
Unit=mm

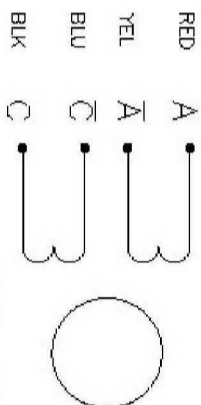
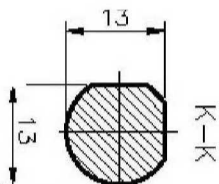
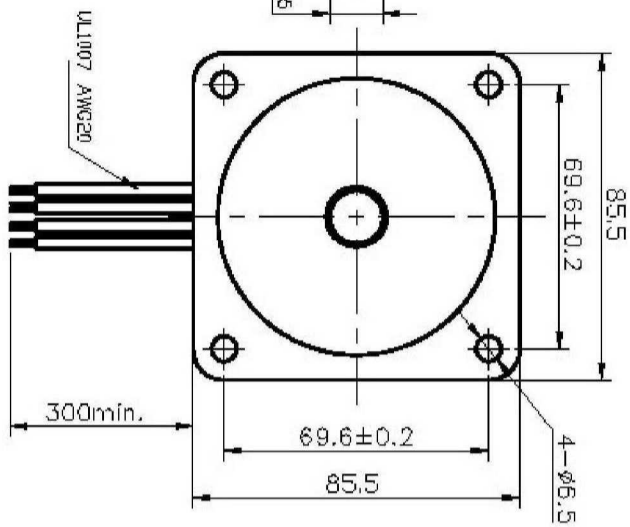
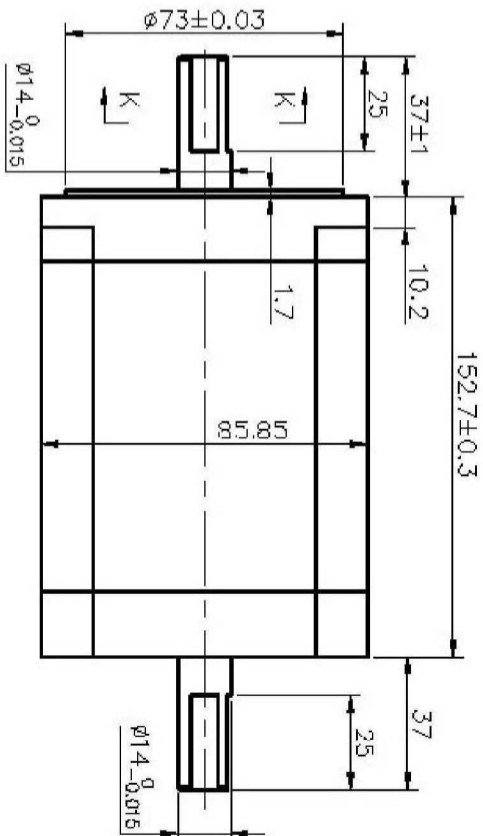

Wiring Diagram:

Specifications:

Phase	4			
Step Angle	1.8			deg.
	PARALLEL	UNIPOLAR	SERIES	
Voltage	3.67	5.25	7.35	V
Current	5.88	4.2	2.94	A
Resistance	0.625	1.25	2.5	Ω
Inductance	8	8	32	mH
Holding Torque	12.2	8.5	12.2	N.m
Insulation Class	B			
Mass	5.3			kg
Color	Blue			

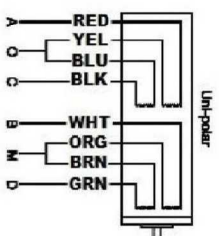
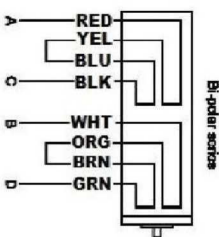
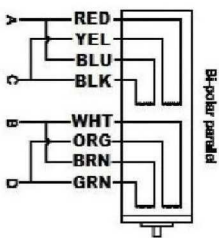

Action
Technology

SM1.8-E85120-CS

MotorType: SM1.8-E85120-CS
6A/PH 400step/rev PARALLEL 48VDC

