

Dimension:  
Unit=mm

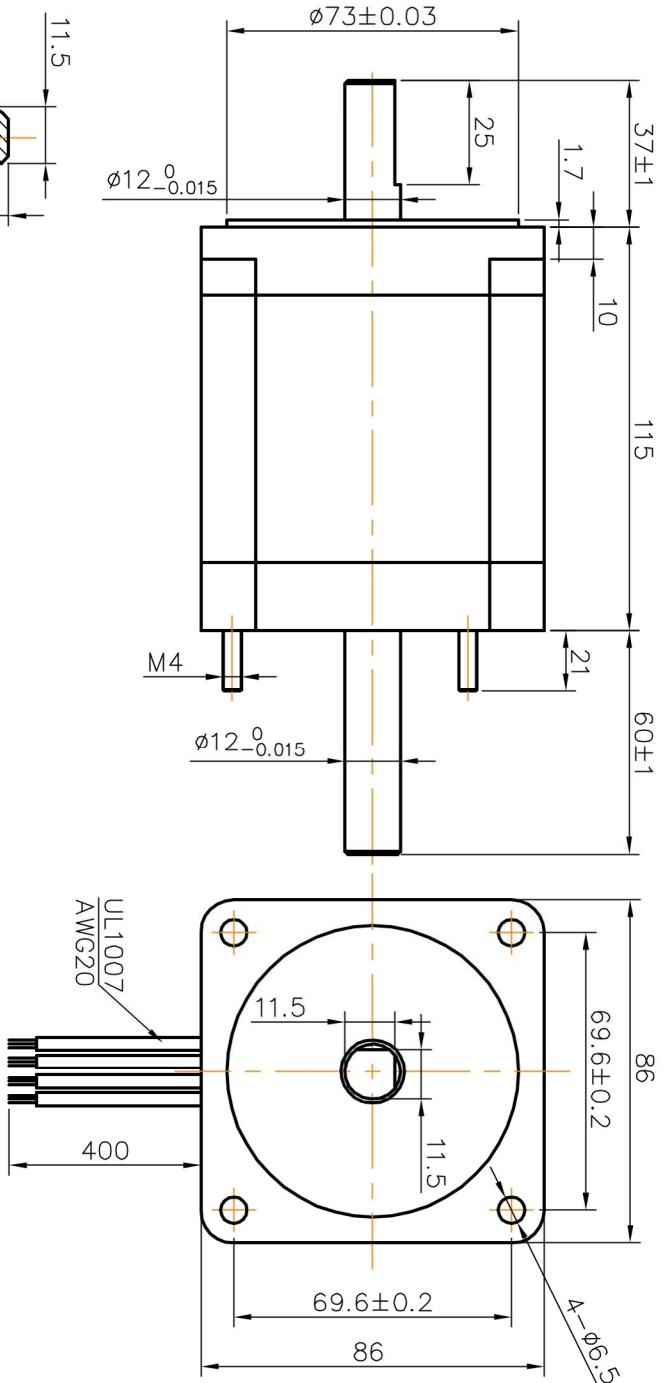

Wiring Diagram:

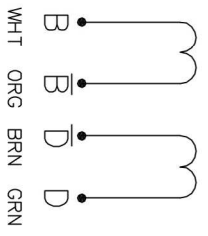
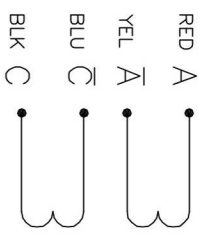

Specifications:

Phase	4			
Step Angle	1.8			deg.
	PARALLEL	UNIPOLAR	SERIES	
Voltage	2.7	3.78	5.3	V
Current	5.88	4.2	2.94	A
Resistance	0.45	0.9	1.8	$\Omega$
Inductance	6	6	24	mH
Holding Torque	8.7	6.1	8.7	N.m
Insulation Class	B			
Mass	3.8			kg
Color	Blue			

Title:  
Specification

ACTION  
TECHNOLOGY  
SM1.8-E8590P-CS

Motor Type: SM1.8-E8590P-CS

6A PH 400st ep/rev PARALLEL 48VDC

